



PK-30 system® 

SLIDING DOOR SYSTEM • OPERABLE WALLS • PARTITIONS



**FOLDING WALL,
FIXED PANELS AND
SWING DOORS**

Architect: Eric J. Smith Architects

PK-30 folding operable partitions open up infinite possibilities, featuring extremely quiet running properties, low parking area space requirements and excellent quality.

Photo: Laura Moss

PK-30 SYSTEM

is a meticulously designed and engineered aluminum demountable wall system providing a flexible, environmentally friendly and cost-effective way to divide interior space. The System can be used in widely varying configurations including sliding doors, swing doors, fixed panels and operable walls, all utilizing the same narrow aluminum profiles. Continuity of multi-functional architectural elements; a systematic, modern, precise design language from a single source manufacturer. The system accepts any $\frac{1}{4}$ " to $\frac{1}{2}$ " thick panel material allowing unlimited design choices. Components are extruded from high-grade 6000 series aluminum alloy with 32% recycled content, allowing narrow profiles that are rigid and lightweight. Satin anodized finishing gives the material a soft sheen that resists corrosion and is easy to clean.

.....

"The team at PK-30 has consistently impressed us with their attention to detail, their meticulously prepared shop drawings and their beautifully executed product."

—JERRY CALDARI,
BROMLEY CALDARI ARCHITECTS

.....

"The slim aluminum frame profile and the ability to insert a wide range of panel materials make the system particularly attractive."

—ARJUN DESAI,
DESAI CHIA ARCHITECTURE



OPERABLE WALLS

Architect: Jattuso Architecture PLLC

Operable walls open up infinite possibilities.

- **Centerfold** is a high quality accordion wall hardware system for variable room partitions up to 39 feet in width. The suspension point for this system is located at the panel center. Extremely wide installations are possible without bottom guide channels.
- **Variofold** is a high quality bi-folding wall system. A bottom guide channel provides firm stability for installations with more than two doors per side.
- **Variotec** is a sliding stacking solution. Its modular, pluggable track system will follow your plans around and into every corner, giving you free rein even for large-scale installations. You may neatly stack a virtually limitless number of panels in the parking area. The sliding/stacking top tracks may be bent to customer specifications within 15° to 90° .





SWING DOORS WITH FIXED PANELS

Ampersand Architecture

Our center hung pivot doors may be single or double-acting, with or without transoms. Hardware such as concealed floor closers, surface mounted closers, electromagnetic locks, full mortise locks and electric strikes may be integrated into the system.

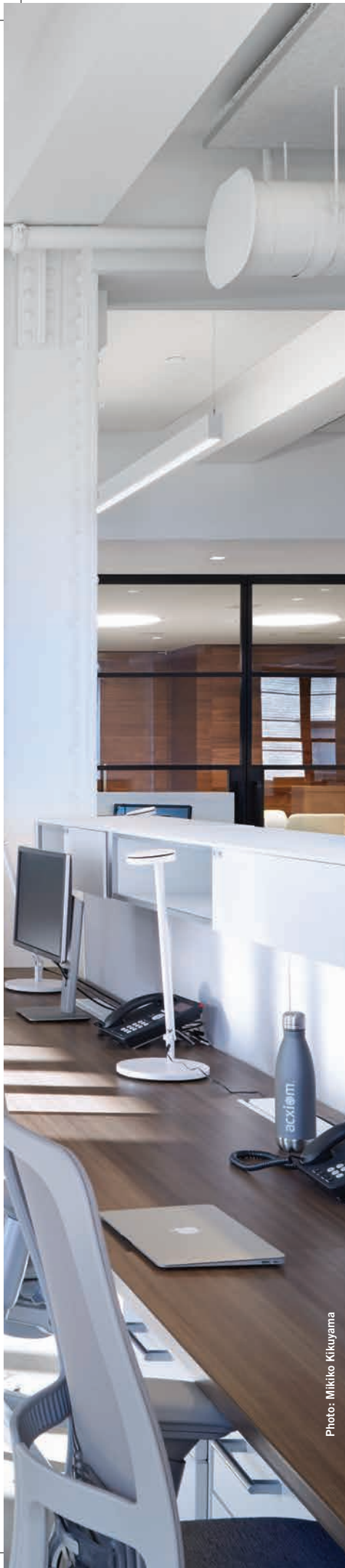

Photo: Mikiko Kikuyama

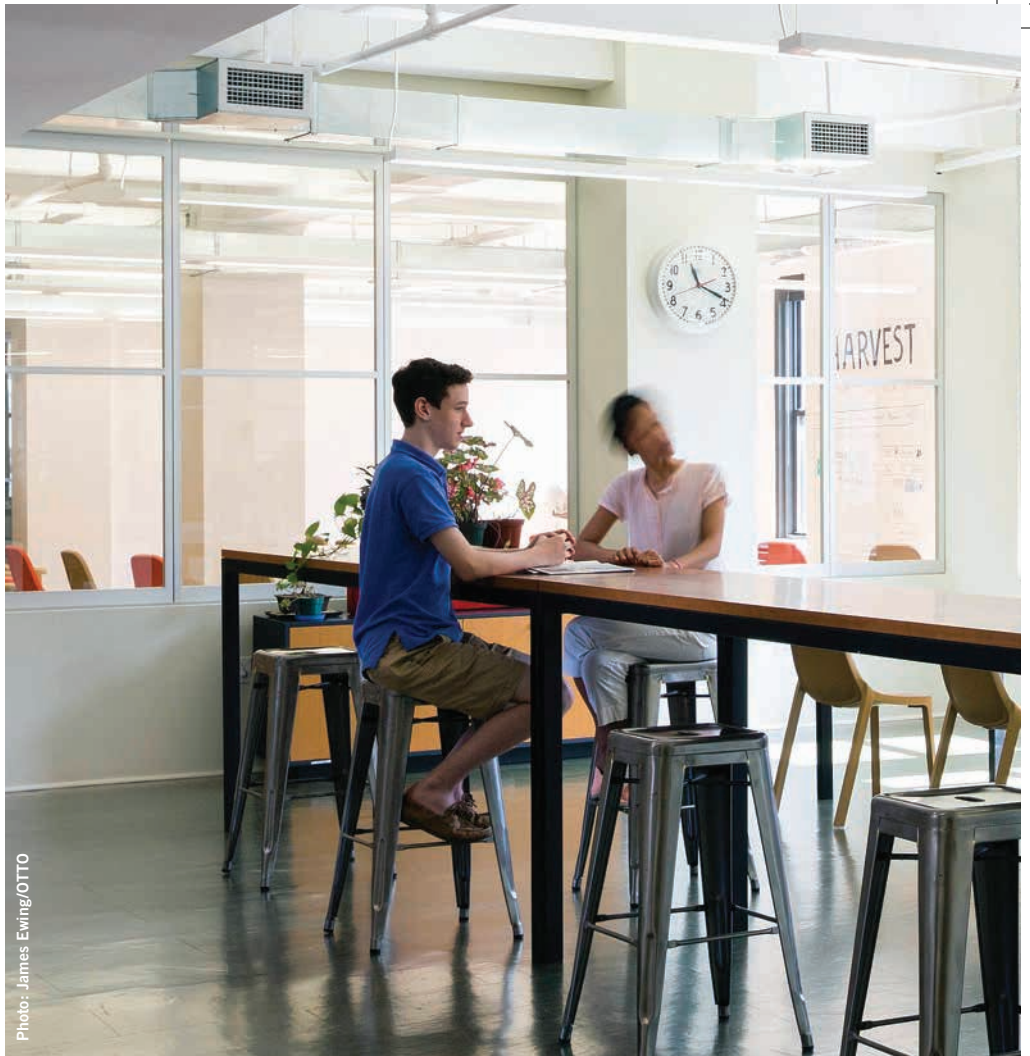

Photo: James Ewing/OTTO

▲ FIXED PANELS

Front Studio Architects LLC

Fixed panels up to 12 feet in height and up to 12 feet in width are standard. Vertical, horizontal or crossed mullions may be specified. All fixed panels have built-in height and side wall adjusters in order to accommodate out of level or plumb conditions. Floor to ceiling and partial height fixed panels may be specified.

CURVED WALLS >

Flad Architects
Kohn Pedersen Fox & Associates

Segmented curved walls are possible with fixed panels or sliding stacking installations. The sliding stacking top tracks may be bent to customer specifications within 15° to 90°.

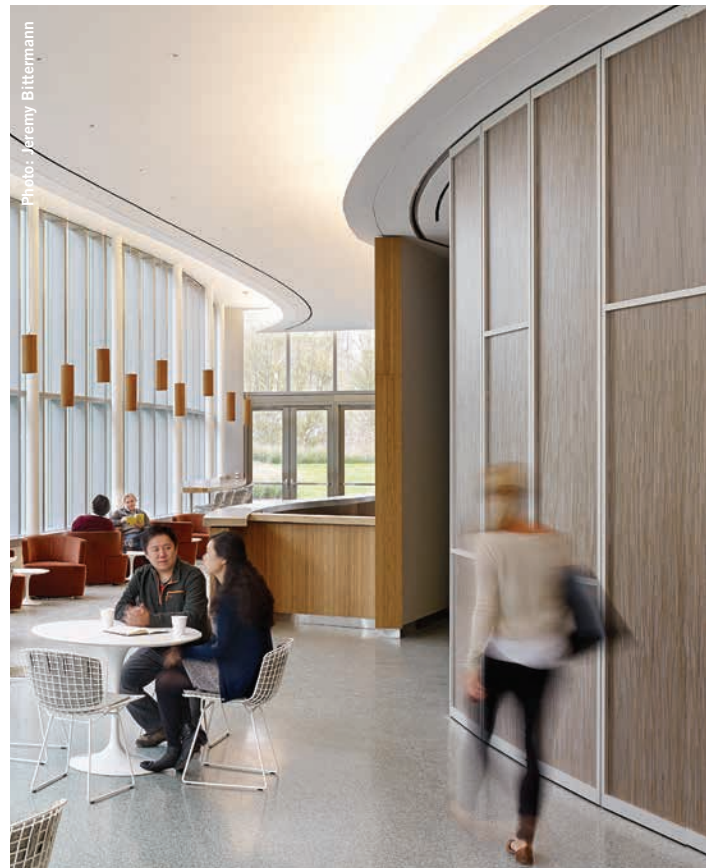
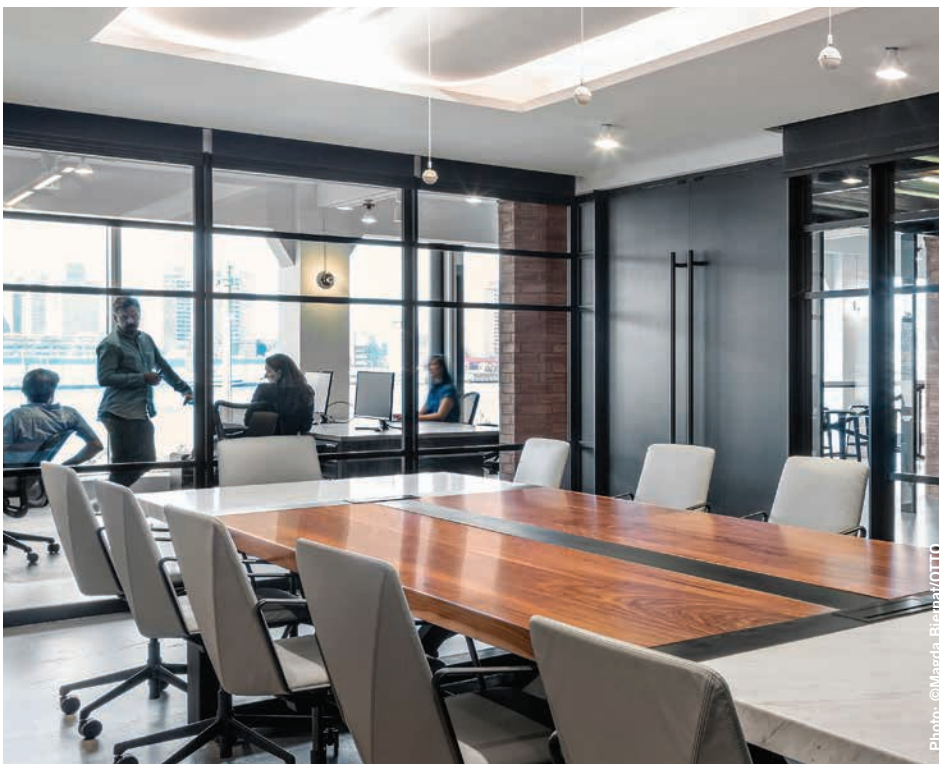

Photo: Jeremy Blittermann



Photo: David Lauer



^ WOOD SWING DOOR WITH FIXED PANELS

Architect: vonDALWIG Architecture

Factory finished flush wood doors are made to order and pre-machined for hardware, saving time, ensuring quality and accuracy.

< SLIDING DOORS WITH FULL MORTISE LOCK

Architect: JNS Architecture + Interior Design

v SLIDING DOORS WITH BAR PULLS

Architect: ESG Architecture & Design

Sliding doors up to 10 feet wide and up to 12 feet high are standard. PK30 System sliding hardware fittings offer innovative, efficient solutions for doors weighing up to 450 lb. Continuous recessed bottom guide channels add stability but are not required in most applications. FSB sliding door locks with vertically mounted levers are standard, North American cylinders allow you to match building standard keyways. Glass mounted bar pulls, bottom rail locks and electromagnetic locks are available.



BUTT GLAZING

Front and back cover

Enhanced minimal design, clear sight lines and wide expanses of glass without the use of vertical framing members is achieved by specifying butt glazed fixed panels. Panels up to 12 feet wide may be butt glazed as well as 90° inside and outside panel corners.

LOCKS

We recognize the important role played by the door hardware in providing our customers with a quality finished product. That is why we have partnered with FSB USA. FSB's lever designs are so admired that four have been added to MoMA's permanent collection. Swing door mortise locks are available in all standard functions. Sliding door mortise locks are available for entry and privacy doors. The sliding pocket door lock has an integral edge pull. Choose from FSB's extensive selection of levers, knobs and flush pull trims in various metals and finishes.



Front and Back Cover:

Design by Ghiora Aharoni Design Studio,
New York

ENVIRONMENT

PK-30 System has committed to environmental stewardship by becoming a member of the USGBC and by designing its products to meet the strictest environmental standards, including LEED. The LEED® (Leadership in Energy and Environmental Design) Green Building Rating System is a voluntary, consensus-based standard for developing high-performance, sustainable buildings created by the U.S. Green Building Council. The LEED program has gone through numerous updates since its first release. Visit our website for a report on how the following LEED v4/v4.1 ratings directly apply to projects that will use PK-30 System products.

Building Product Disclosure and Optimization:

- Environmental Product Declarations Credit
- Sourcing of Raw Materials
- Material Ingredients

Design for Flexibility Credit**Construction and Demolition Waste Management****Low-Emitting Materials****Daylight****Quality Views****CONTACT INFORMATION:**

PK-30 System Inc
P.O. Box 656
Stone Ridge, NY 12484
t. 845.687.9774
f. 888.653.1394
info@pk30system.com
www.pk30system.com



Photo: Aviad Bar Ness